

**Application Ref: NP/11/091**

**Application Type** Full  
**Grid Ref:** SN08973646  
**Applicant** Countryside Council for Wales  
**Agent** Mr D Williams, Countryside Council for Wales  
**Proposal** 2 new interpretation panels  
**Site Location** Ty Canol National Nature Reserve, Felindre,  
Pembrokeshire

**Summary**

This application is brought before the Development Management Committee as it proposes to erect 2 information panels along the public right of way routes of the Ty Canol National Nature Reserve (NNR), which is land owned by the Pembrokeshire Coast National Park Authority. It is considered that the proposed information panels represent a sensitive and acceptable approach to providing public information in association with the Reserve. They are not considered to cause an unacceptable detrimental impact upon the existing nature conservation interest or visual attractiveness of the area and will promote the public understanding and enjoyment of Ty Canol NNR. The application is therefore considered to comply with the relevant policies of the LDP and as such is recommended for approval.

**Consultee Response**

**Nevern Community Council:** No Response Received

**Public Response**

None Received

**Policies considered**

LDP Policy 01 - National Park purposes and duty  
LDP Policy 07 - Countryside  
LDP Policy 08 - Special Qualities  
LDP Policy 10 - Local Sites of Nature Conservation or Geological Interest  
LDP Policy 11 - Protection of Biodiversity  
LDP Policy 15 - Conservation of the Pembrokeshire Coast National Park  
LDP Policy 29 - Sustainable Design  
LDP Policy 30 - Amenity  
PPW4 Chapter 04 - Planning for Sustainability  
PPW4 Chapter 05 - Conserving and Improving Natural Heritage and the Coast  
PPW4 Chapter 06 - Conserving the Historic Environment

SPG03 - Sustainable Design  
SPG08 - Validation of Planning Applications  
TAN 05 - Nature Conservation and Planning  
TAN 12 - Design

## **Officer's Appraisal**

### **Background and Description**

Ty Canol NNR is located within the open countryside of the Preseli hills in North Pembrokeshire. It comprises a largely wooded area with a number of public rights of way routes running through it and around part of the boundary, the area of the Reserve is approximately 70 hectares. The Reserve represents an extremely sensitive and important location in relation to its contribution to the overall natural beauty, cultural heritage, public enjoyment and understanding of the Park. In addition to its NNR status, the site is also a designated Historic Landscape, Site of Special Scientific Interest (SSSI), Special Area of Conservation (SAC) and an Ancient Semi Natural Woodland (ASNW).

### **Current Proposal**

The proposal seeks to erect 2 information panels within the Reserve, one along the public right of way route which runs along the South Western boundary and one within the Northern wooded area, also located near to the public right of way route which runs through this wooded area from North to South.

### **Key Issues**

- The proposed design, siting and scale of the information boards in relation to their impact upon the existing nature conservation interest and visual attractiveness of the Reserve.
- The impact upon the amenity levels enjoyed within the Reserve.

### **Analysis**

The same design and scale of information panel is proposed for both locations. The frames on which the panels will be mounted measure 1.3m high by 1.m wide with a breadth of 0.45m. The frame will be in Douglas fir timber and will be left to weather naturally. The design consists of 4 uprights which will support a pitched roof. The uprights will be 150 x 100mm thick. The information panel will be digitally printed onto a 3mm aluminium sheet, finished with a resinous layer for protection.

The panels will be sited along defined public rights of way routes. This helps to ensure that the panels are located in the most advantageous positions in relation to viewing numbers as well as helping to minimise any additional erosion to the land from footfall as members of the public will not need to

deviate from the route to view the panels. As a result of their scale and design, they are not considered to be visually intrusive in the context of the wider natural landscape.

It is considered that the proposed scale, siting and design of the panels represents a sensitive and acceptable approach to providing public information in association with the Reserve. They are not considered to cause an unacceptable detrimental impact upon the existing nature conservation interest or visual attractiveness of the area and will promote the public understanding and enjoyment of Ty Canol NNR.

**Recommendation:**

Approve

**Conditions/Reasons:**

Standard conditions relating to time limit and compliance with plans..

50

1000

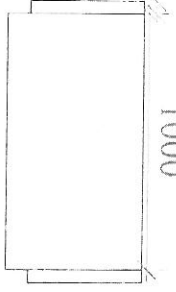

Interpretation Panel  
Front, Rear & Side Elevations  
& Plan

Scale 1:10

Sectional Plan

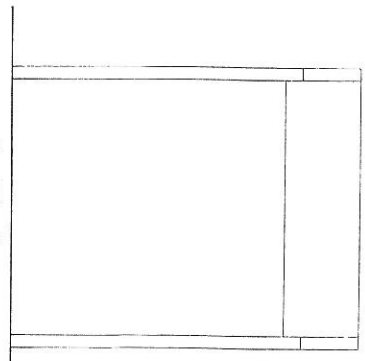

Front Elevation

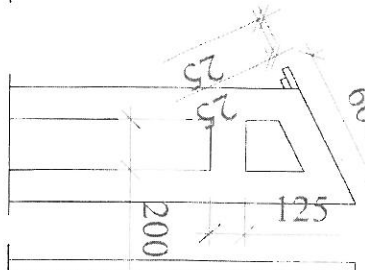

Sectional Elevation

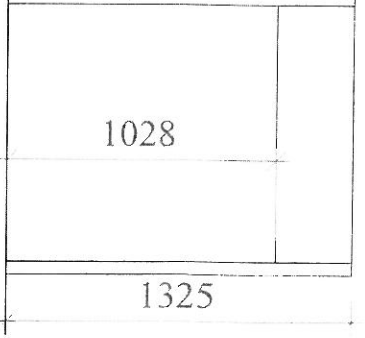

Rear Elevation

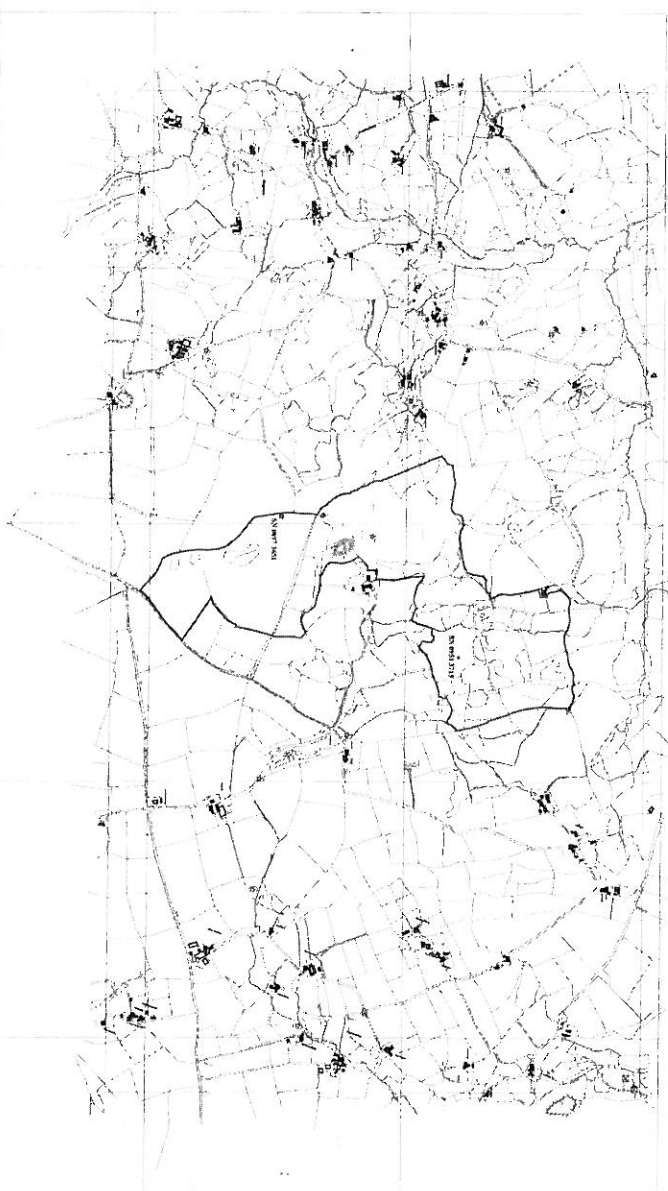

Ty Canol NNR - Scale 1:10 000 Sign locations

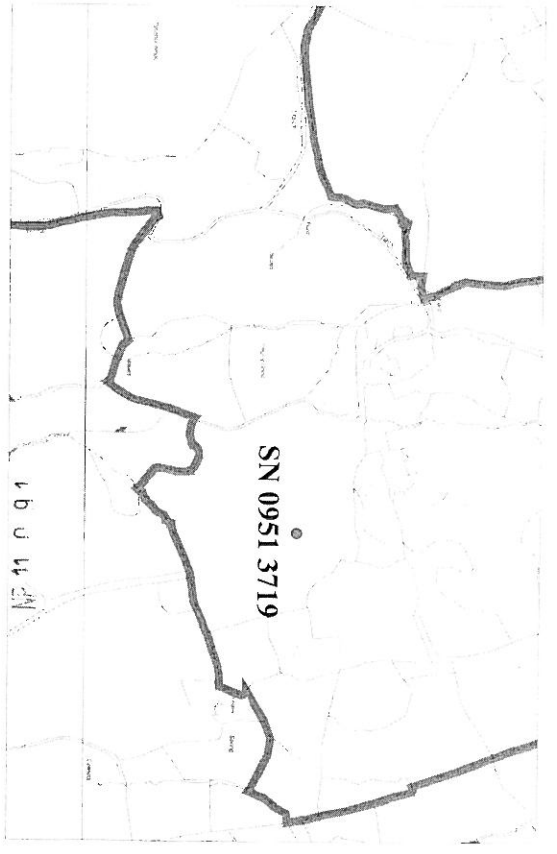

Scale 1:2500 Sign Location

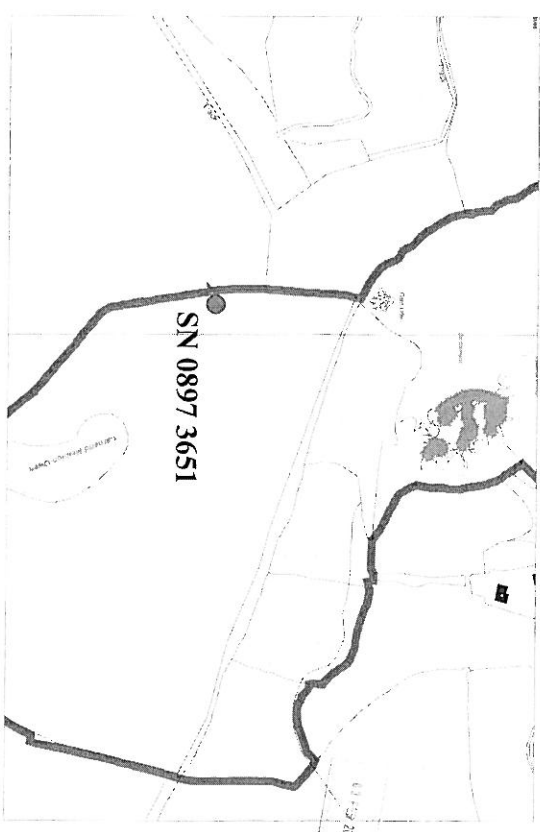

Scale 1:2500 Sign Location

Ty Canol NNR

Proposed: New Interpretation Panels

Date 17th Jan 2011

Version 1

Scale 1:10 000 1:2500 1:10

Daryl Williams

