

Application Ref: NP/11/527

Application Type	Full
Grid Ref:	SM80220780
Applicant	Mr P Smithies
Agent	
Proposal	Installation of 15Kw wind turbine and associated foundation pad & underground cable
Site Location	Philbeach Farm, Dale, Haverfordwest, Pembrokeshire, SA62 3QU
Case Officer	Richard James

Summary

This application was reported to the March 2012 meeting as the views of your officers differed from those of the Community Council. The application was recommended for refusal on visual impact grounds, where, as a result of its visibility within the local landscape, it was considered that the turbine would be detrimental to the special qualities of the National Park. At the March 2012 meeting, members resolved to undertake a site visit in order to fully assess the visual impact of the proposed turbine. A site visit was conducted on the 2nd April, a pole was erected on site which displayed the height to the hub and blade tip, members then visited numerous sites within the local area to assess the visual impact. It remains your officers' view that the proposed turbine would have an adverse visual impact upon the special qualities of the National Park, as such, the application is recommended for refusal.

Consultee Response

Marloes & St Brides Community Council: Supporting
Dale Community Council: Reply - No comment
St Ishmaels Community Council: No objection
PCC - Transportation & Environment: No objection
Commercial Pollution Section- PCC: Conditional Consent
Dyfed Archaeological Trust: No objection
MOD: No objection
NATS: No objection
Countryside Council for Wales: No objection

Public Response

Several letters from members of the public have been received supporting the proposal, the letters raise points relating to:-

- Wind as an alternative form of energy must be supported for dwellings, farms and businesses within the National Park to assist in sustaining its economy.

Item 6 - Report on Planning Applications

- As this is a single turbine for a dwelling it has minimal impact on the local environment and landscape and is not obtrusive.
- The proposal is set down in a valley away from the coastal edge and away from position e.g. on the skyline.
- The energy created by the wind turbine is crucial for the sustainability of the existing farm house and will be used to heat the building.
- The siting of the wind turbine is sympathetic and utilises local topography, hedges and buildings to conceal it.
- The height at 15 metres to the hub is not excessive and is normal for a domestic situation and the proposal will not impact on amenity.
- The proposal will blend in with the adjacent telegraph poles and airfield buildings, and be no more detrimental to the landscape than these structures.

Policies considered

LDP Policy 01 - National Park Purposes and Duty
LDP Policy 07 - Countryside
LDP Policy 08 - Special Qualities
LDP Policy 11 - Protection of Biodiversity
LDP Policy 15 - Conservation of the Pembrokeshire Coast National Park
LDP Policy 29 - Sustainable Design
LDP Policy 30 - Amenity
LDP Policy 32 - Surface Water Drainage
LDP Policy 33 - Renewable Energy
LDP Policy 53 - Impacts on traffic
PPW4 Chapter 04 - Planning for Sustainability
PPW4 Chapter 05 - Conserving and Improving Natural Heritage and the Coast
PPW4 Chapter 08 - Transport
PPW4 Chapter 12 - Infrastructure and Services
PPW4 Chapter 13 - Minimising and Managing Environmental Risks and Pollution
SPG03 - Sustainable Design
SPG06 - Landscape Character Assessment Study, June 2009
SPG08 - Validation of Planning Applications
SPG14 - Renewable Energy
TAN 05 - Nature Conservation and Planning
TAN 06 - Planning for Sustainable Rural Communities
TAN 08 - Renewable Energy
TAN 11 - Noise
TAN 12 - Design
TAN 18 - Transport

Officer's Appraisal

Background

This is a full planning application for a 15kw wind turbine, to generate electricity for Philbeach Farm and its diversified tourism enterprise. The turbine is classed as "Small Scale", measuring 15m to the hub and 21m to the blade tip. It will be located 180m South West of the existing farm buildings on the complex. This application was reported to the March 2012 meeting (a full copy of that report is attached).

At that meeting, members resolved to undertake a site visit in order to fully assess the visual impact of the proposed turbine. A site visit was conducted on the 2nd April 2012. The applicant erected a pole at the site location, to display both hub and blade tip height. This was measured and confirmed to be correct by your officer on site. Members then visited numerous sites within the local area to assess the visual impact.

Following from the previous report, it is considered that the proposed turbine would have an adverse visual impact upon the special qualities of the National Park. The proposed turbine would be highly visible in many views within the Marloes Peninsula and from the Public Right of Way and the coast path across the Gann estuary, and the waterway. This turbine, in a prominent location and of a scale which comprises skyline development in many views, would significantly detract from the special qualities of the National Park at the Marloes Peninsula.

There are no opportunities to mitigate the impact from views within the area. The turbine is sited away from farm buildings and they do not provide a context for it from key views. From Musselwick area, the site would have a strong relationship with the coast and 'Gann Estuary' and when viewed from the network of public rights of way within this area it would compromise the landscape backdrop to the estuary.

Recommendation

The application is therefore considered to conflict with the relevant policies of the Local Development Plan and as such is recommended for refusal for the following reason:-

The proposal by reason of its prominent location, its height and scale resulting in a skyline development which will be visible from many public vantage points. This will have an adverse visual impact and will therefore significantly detract from the special qualities of the National Park. The proposal is therefore contrary to Pembrokeshire Coast National Park Development Plan (adopted September, 2010), Policy 1 (National Park Purposes and Duty) (a and b); Policy 8 (Special Qualities) (c); Policy 15 (Conservation of the Pembrokeshire Coast National Park) (a, b, c and d) and Policy 33 (Renewable Energy). It is also contrary to Planning Policy Wales Edition 4 (paras.12.8.9-10) and TAN 8 (Annex D para.8.4).

ATIONAL GRID PLANS Scale 1:2500 Part SM 80087

1973

8/12/11

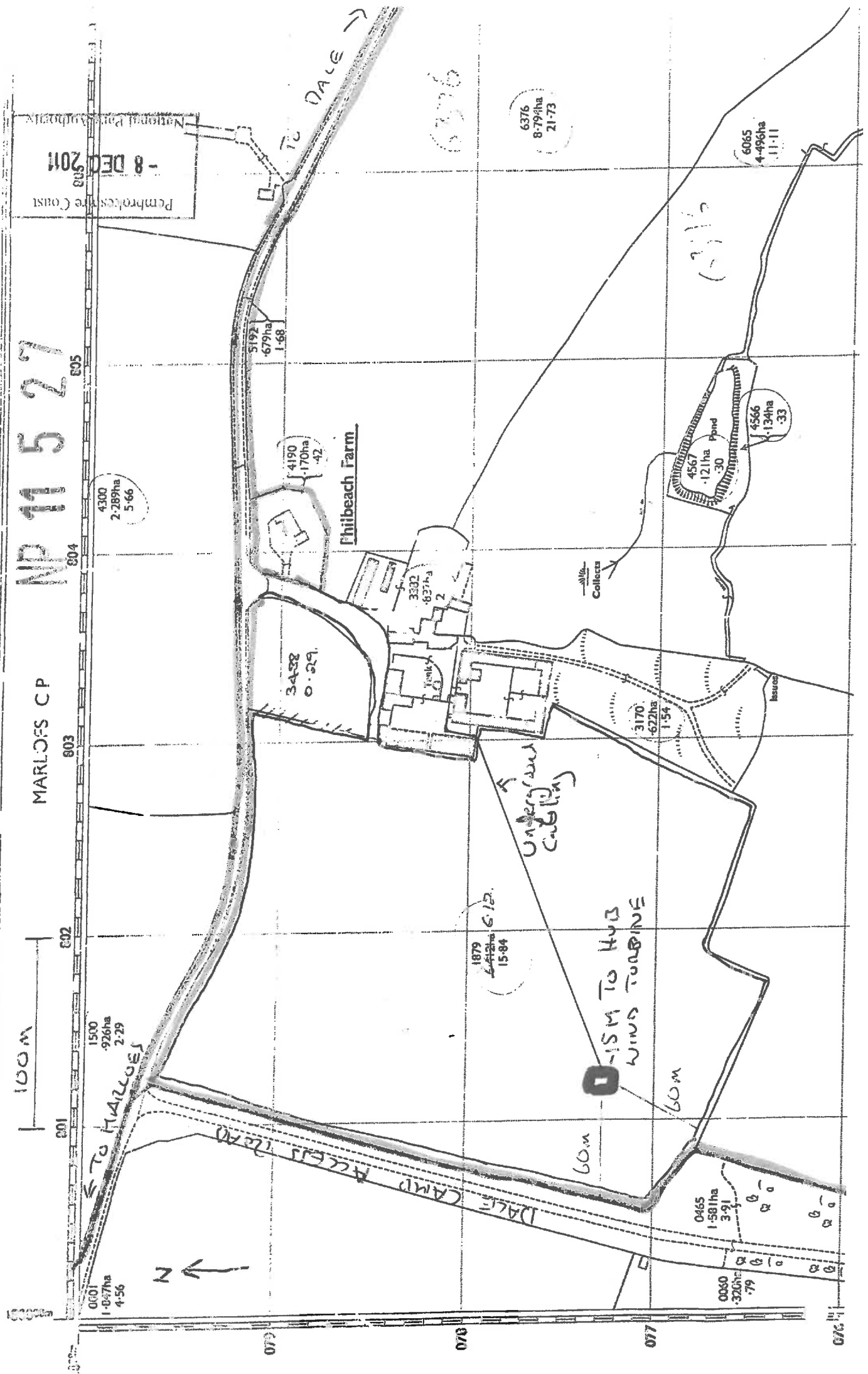

NP 11 5 27

MARLOES CP

100M

801 802 803 804

1500
1.926ha
2.29

0001
1.87ha
4.56

4300
2.289ha
5.66

4190
170ha
.42

34538
0.29

1879
4.422ha
15.84

3302
837ha
2

6376
8.799ha
21.73

612

60m

1
15M TO HYD
WIND TURBINE

60m

3170
622ha
1.54

4567
12.1ha
30

4566
134ha
.33

0465
1.581ha
3.91

0060
320ha
.79

6065
4.496ha
11.11



- 8 DEC 2011
Perthores the Coast
National Park Authority

DALE CAMP ACCESS ROAD

DALE

6376

6376

079
078
077
076

**OVERALL DIMENSIONS FOR CF15 TURBINE:
15kW GENERATOR / 15m MAST / 5m BLADES**

NP 11 5 27

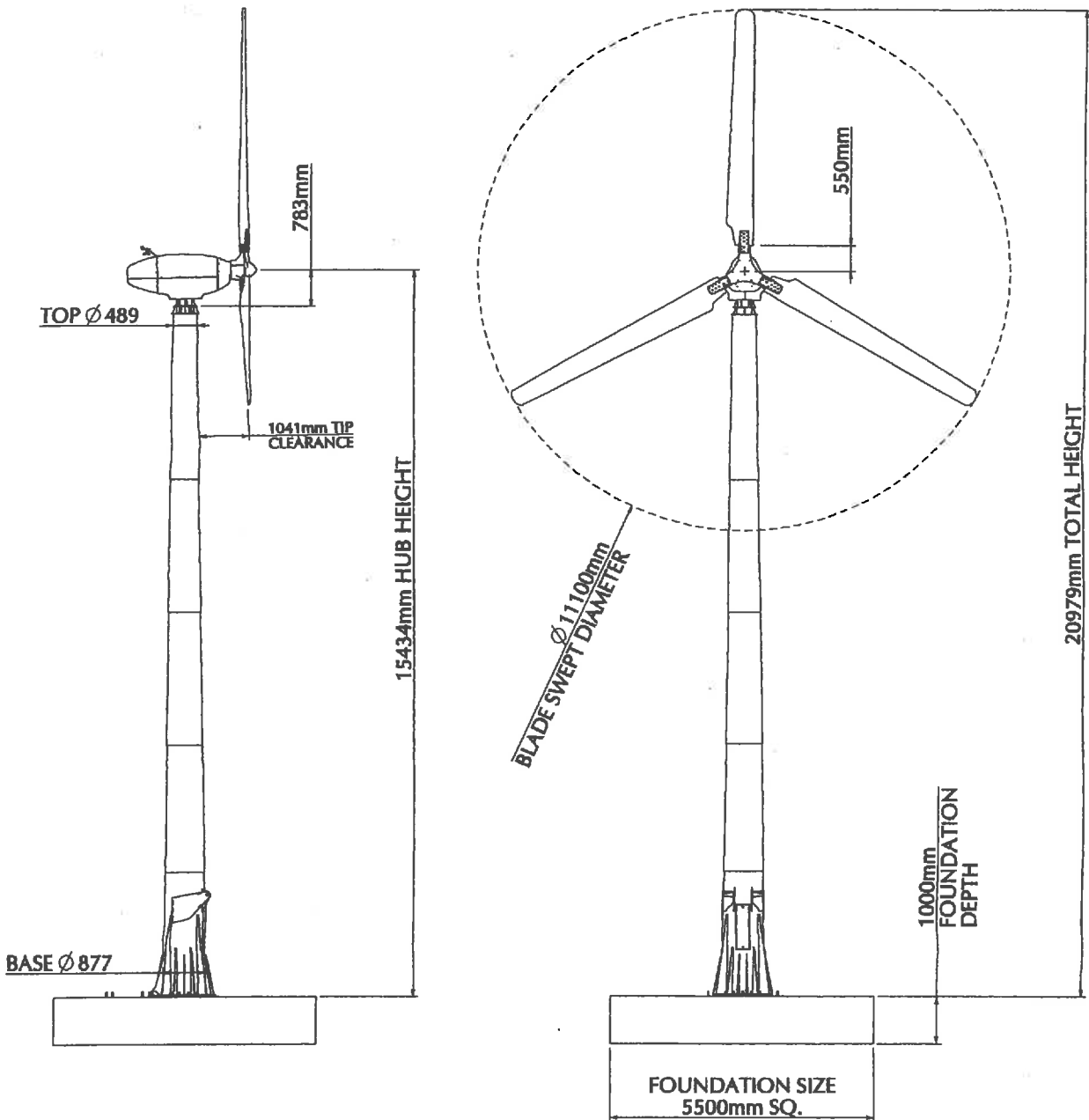
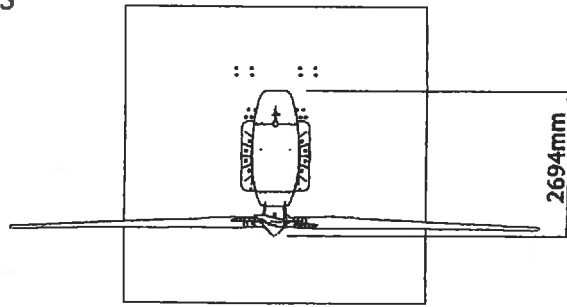

Pembrokeshire Coast
- 8 DEC 2011
National Park Authority



C&F Green-Energy		CF15 All Dimensions in mm	
DESCRIPTION: OVERALLS / PLANNING		QTY PER UNIT: -	SCALE: 1:100
MATERIAL: Mesh: S275 Galv	DRAWN: C O'Neill		DWG SIZE: A3
CHECKED: -	PAINT: -		
DATE: 16-Feb-11	FINISH: -	SHEET: 1 OF 1	