

Application Ref: NP/13/0093

Application Type	Full
Grid Ref:	SN12340388
Applicant	Mr I Westley, Pembrokeshire County Council
Agent	Mr D Jones, Hyder Consulting (UK) Ltd
Proposal	Construction of Civic Amenity & Recycling Centre, incorporating an internal access road, site access improvements, erection of a compactor shed, canopy shed & welfare office, provision of containers, skips & igloos, staff & visitor parking, weighbridge area and quarantine area, lighting & site signage, fencing & landscaping works
Site Location	Land adjoining Brooklands, Saundersfoot, Pembrokeshire
Case Officer	Liam Jones

Purpose of Report

To request that Members undertake a site visit to inspect the site, its context and the surrounding character of the area prior to the application being fully considered at a future meeting of the Development Management Committee.

Background

The application site relates to a parcel of land adjoining Brooklands Nursing Home near New Hedges. The application was received on 25th February 2013 and duly advertised by the Authority in accordance with The Town and Country Planning (Development Management Procedure) Order 2012 through display of a site notice, letters to neighbouring occupiers and advertisement through the press.

A number of objections to the scheme have been received and details of which will be provided as part of a full report to be presented to Authority's Development Management Committee on 19th June 2013.

Current Proposal

The application proposes the construction of a Civic Amenity and Recycling Centre on land adjoining and to the west of Brooklands Nursing Home. At present the site comprises a large open area of rough grassland with surrounding areas of woodland and other vegetation.

The scheme involves the provision of a range of waste management facilities to be contained within a central operating area and served by a public access road directly from the A478 which abuts the south boundary of the application site. The purpose is to provide a waste management facility for the collection and segregation of municipal refuse, serving the National Park Authority as well as the County Council area. The applicants explain that the primary

objective of the facility is to provide separate containment facilities for segregating recyclable materials from waste that will be disposed to landfill.

The proposed Civic Amenity and Recycling Centre comprises the following components:

- Weighbridge facility area;
- Widened site access;
- Site access roads and dedicated parking bays;
- 9 large open topped containers;
- 1 trailer type container;
- 1 self-contained compacting container and 1 closed top skip for public service wastes;
- Compaction skip shed;
- Canopy shed for dry recyclables;
- 4 small skips for glass and cans;
- 5 container skips in public access areas;
- 5 small igloos;
- Welfare office;
- Staff and visitor car parking;
- Quarantine area for the temporary storage of any unlicensed materials;
- Perimeter and internal site fencing;
- Lighting, signage and CCTV;
- Landscaping scheme.

The application has been supported with the following documentation and details of which are available to inspect at the National Park Authority offices:

- Design and Access Statement;
- Environmental Report;
- Planning Report;
- Coal Mining Risk Assessment Report;
- Transport Statement;
- Public Consultation Report;
- Proposed Drainage System.

Considerations

This application involves a range of material planning considerations and due to its proposed siting and the level of public concern received to date it is considered essential that members undertake a site visit prior to the June 2013 Committee Meeting. This will ensure that Members are fully informed as to the siting of the proposed scheme, its form and potential impacts before making a decision on the application.

Recommendation

That members of the Development Management Committee inspect the site before consideration of the application at a future meeting.

NP 13 0 9 3

POC LAND OWNERSHIP REMOVED	01/6/12
C SITE AREA MARKED	01/6/12
B SITE AREA MARKED	01/6/12
A POC LAND OWNERSHIP ADDED	01/6/12
REV	DATE
1	01/6/12



Rembroke Shire County Council, Cingor Sir Penfro
 100, High Street, Penfro, Carmarthen, SA31 1JY
 Tel: 01292 350100 Fax: 01292 350101
 www.rembrokeshire.gov.uk

NEW HEDGES CIVIC AMENITY AND RECYCLING CENTRE
 REFERENCE: CA3502_P1.001

DATE	01/6/12
SCALE	1:1250 AT A1
PROJECT	NEW HEDGES CIVIC AMENITY AND RECYCLING CENTRE
PLAN	LOCATION PLAN
PROJECT NO.	CA3502_P1.001

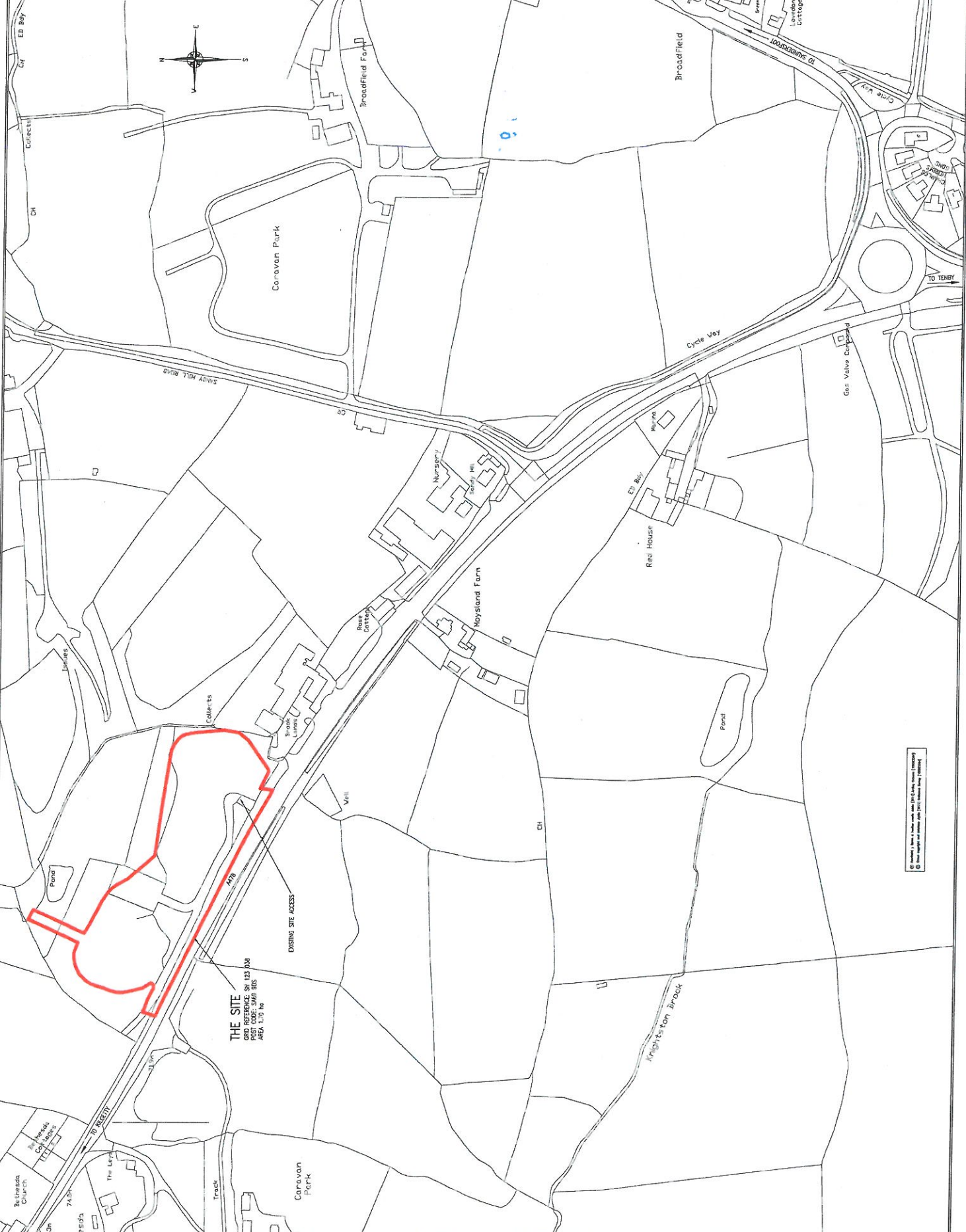

© Rembroke Shire County Council 2012. All Rights Reserved.
 © Rembroke Shire County Council 2012. All Rights Reserved.

